

KOOLAIR

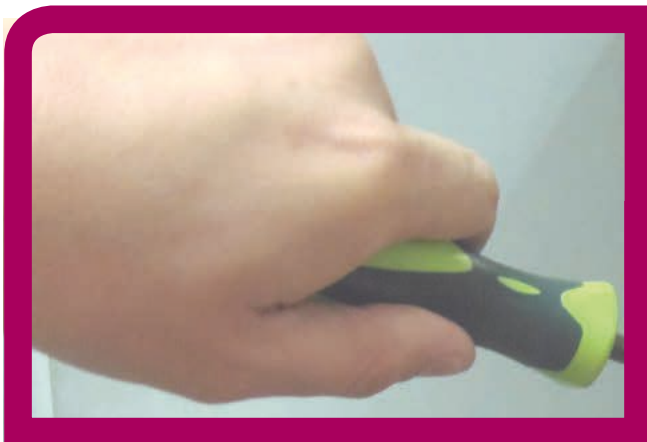

Long-throw
diffuser



DF-47-TR

Mounting
instructions

www.koolair.com

Long-throw diffuser DF-47-TR

Installation instructions

DF-47-TR Installation instructions

To install the DF-47 TR diffuser:

1.- For correct installation and optimum operation the diffuser must be installed with the offset angle label located on the top side of the diffuser (Figure 1).

Use the pre-drilled holes to securely fasten the diffuser to the duct or wall. Once fastened, ensure that the moving part of the diffuser does not touch or rub against any external obstruction.

Figure 1

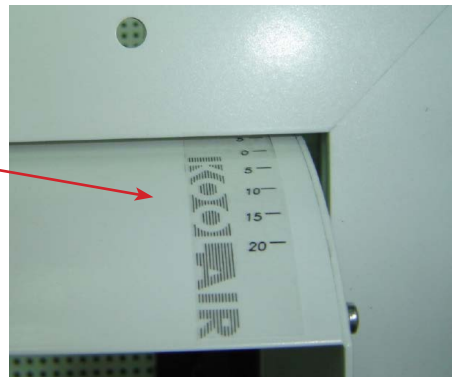
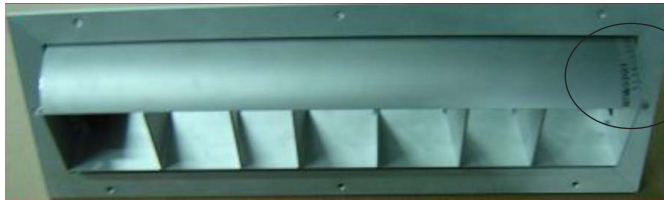

“The numbers should be correctly displayed, with the grade label on top and right“

2.- Adjusting offset angle of the temperature-adjustable DF-47-TR.
The DF-47-TR diffuser has the capability of being directed up at an angle of 20° (with respect to the horizontal axis) to supply cold air (Air Temp. $\leq 20^{\circ}\text{C}$) or down 20° to supply hot air (Air Temp. $\geq 30^{\circ}\text{C}$).

In general, the correct angle will depend on the supply air temperature, the height of the installation and the area to be covered. As such, it is recommended that this is evaluated during each project.

COLD AIR $\leq 20^{\circ}\text{C}$



HOT AIR $\geq 30^{\circ}\text{C}$



Figure 2

Unless otherwise defined, the diffuser will be set in the factory to 0° (with respect to the horizontal axis) for cold air and -20° for hot air.

On site, use the following steps to adjust the offset angle:

DF-47-TR

Installation instructions

3.- Adjusting optimum angle for cold air.

Using the offset angle label (Fig. 1) to measure the offset, loosen screw 2 (figure 2); rotate the diffuser to the desired angle; move screw 2 along slot 1 (figure 2) until it touches the moving part of the diffuser and re-tighten screw 2.

The maximum possible offset with respect to the horizontal is 20° down (figure 2).

Figure 3

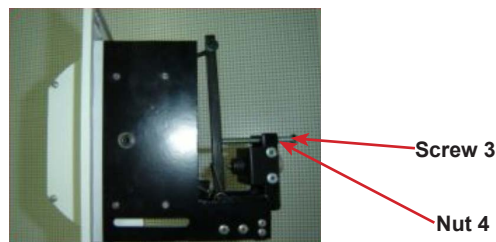

4.- Adjusting optimum angle for hot air.

Using the offset angle label (Fig. 1) to measure the offset, loosen screw 3 (figure 3) until the diffuser reaches the desired angle and then tighten nut 4 against the support. The maximum possible offset with respect to the horizontal is 20° upwards (figure 2).

THIS CATALOGUE IS INTELLECTUAL PROPERTY.

Its reproduction either of a part or its full contents is prohibited without the expressed and authentic consent of KOOLAIR, S.A.

KOOLAIR

KOOLAIR, S.A. (Spain)

Calle Urano, 26

Polig. Ind. nº 2 – La Fuensanta

28936 Móstoles (MADRID)

Tel: +34 91 645 00 33

Fax: +34 91 645 69 62

e-mail comercial: comercial@koolair.com

e-mail Koolair: info@koolair.com

www.koolair.com

Koolair, S.A. reserves the right to change publisher datas and drawings at any time without prior notice written.